

# C.I.P.

# 7 mm Rem. Mag.

Country of Origin: US

TAB. III

Date 84-06-14

Revision 02-05-15

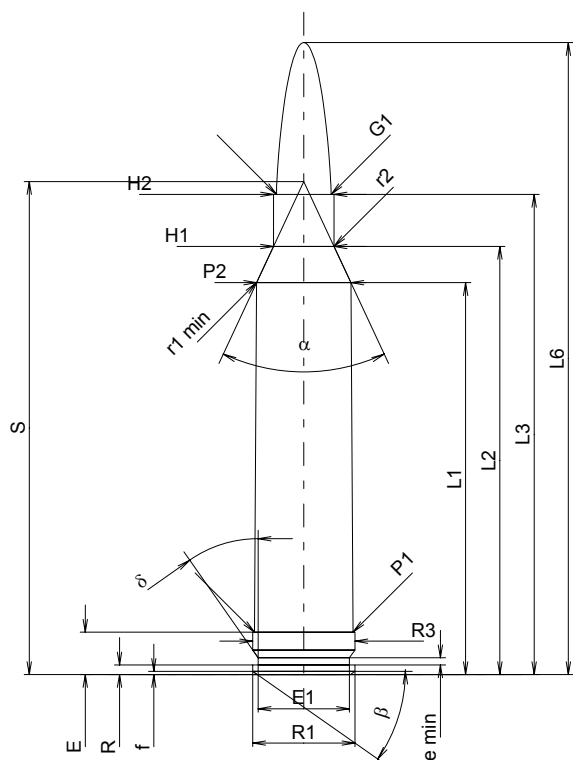

### CARTRIDGE MAXI

#### Lengths

L1	=	51.82
L2	=	56.61
L3 <sup>1)</sup>	=	63.50
L4	=	
L5	=	
L6	=	83.57

#### Case Head

R	=	1.27
R1	=	13.51
R3	=	13.51
E <sup>1)</sup>	=	5.59
E1	=	12.07
e min	=	0.94
delta	=	35°
f	=	0.41
beta	=	35°

#### Powder Chamber

P1	=	13.03
P2*	=	12.47

#### Junction Cone

alpha*	=	50°
S*	=	65.19
r1 min	=	1.02
r2	=	3.18

#### Collar

H1*	=	8.00
H2 <sup>1)</sup>	=	8.00

#### Projectile

G1 <sup>1)</sup>	=	7.23
G2	=	68.61
F	=	
L3+G <sup>1)</sup>	=	68.61

#### Pressures (Energies)

##### Method Transducer

Pmax	=	4300 bar
PK	=	4945 bar
PE	=	5375 bar
M	=	25.00
EE	=	4515 Joule

#### Miscellaneous Dimensions

Fe <sup>1)</sup>	=	0.10
delta L	=	

### CHAMBER MINI

#### Lengths

L1	=	52.03
L2	=	56.79
L3 <sup>1)</sup>	=	64.11

#### Breech

R	=	
R1	=	13.59
R2	=	
R3	=	13.59
r	=	

#### Powder Chamber

E <sup>1)</sup>	=	5.59
P1 <sup>1)</sup>	=	13.06
P2*	=	12.49

#### Junction Cone

alpha*	=	50°
S*	=	65.42
r1 max	=	0.76
r2	=	3.81

#### Collar

H1*	=	8.05
H2 <sup>1)</sup>	=	8.03

#### Commencement of Rifling

G1 <sup>1)</sup> *	=	7.23
G <sup>1)</sup>	=	5.11
alpha1	=	90°
h	=	0.40
s*	=	3.30
i <sup>1)</sup> *	=	3°
w	=	

#### Barrel

F <sup>1)</sup> *	=	7.04
Z <sup>1)</sup>	=	7.21

#### Grooves

b	=	2.79
N	=	6
u	=	241.00
Q <sup>2)3)</sup>	=	40.39 mm <sup>2</sup>

Scale 1:1

Dimensions in << mm >>  
Dimensions and Tolerances for Proof Barrels  
see Appendix CR 1.

Notes: 1) Check for safety reasons  
2) Valid only for Proof Barrels  
3)  
\* Basic dimensions